

**CENTRIFUGAL PUMPS FOR  
DENSE AND VISCOUS LIQUIDS  
VERSATILE PUMPING**



**MULTISTEEL®**  
CENTRIFUGAL PUMPS



**Sales Department**

+55 19 3546.9878

[vendas@bombasmultisteel.com.br](mailto:vendas@bombasmultisteel.com.br)

Multisteel® Centrifugal Pumps

Rod. Washington Luiz, Km 158,6

13490-970 . Cordeirópolis . SP . BR

**[bombasmultisteel.com.br](http://bombasmultisteel.com.br)**

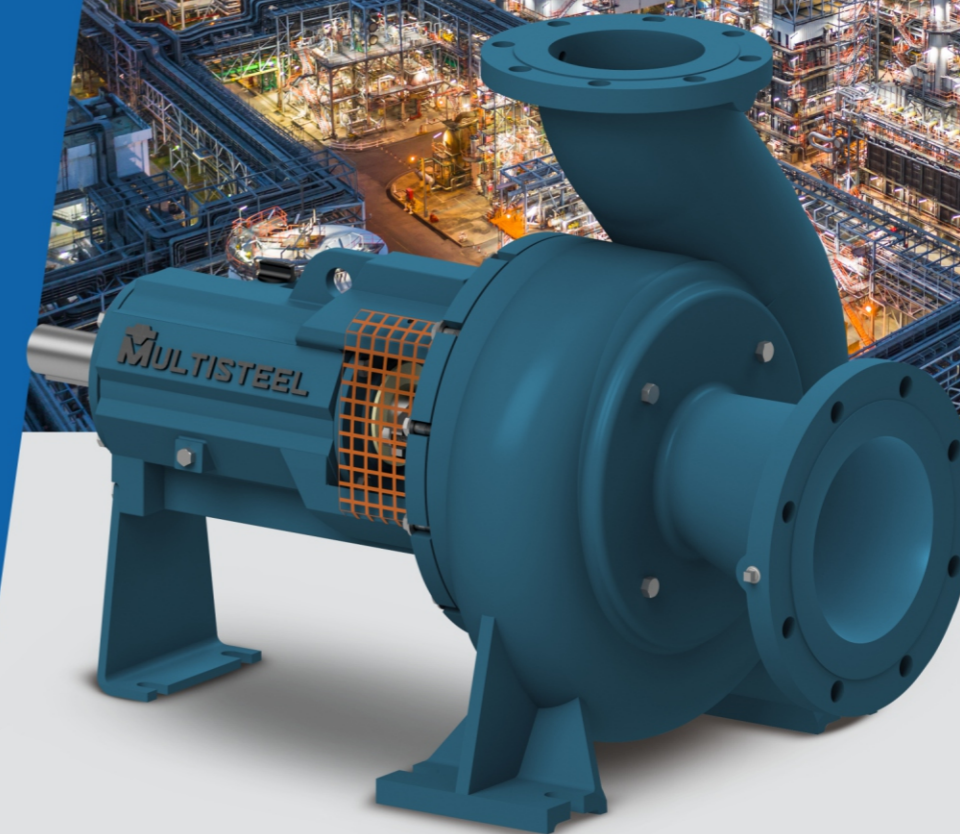

**RA/RT**  
LINE



# RA/RT LINE

**DESIGNED FOR  
PUMPING DIRTY, DENSE,  
AND VISCOUS LIQUIDS**

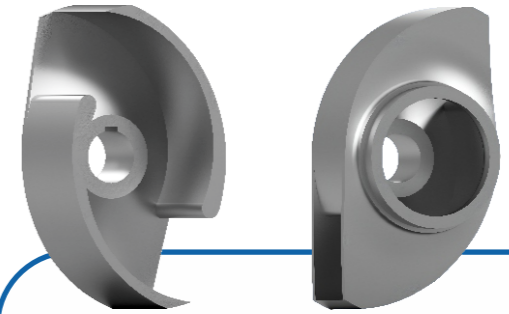

## **OPEN IMPELLER AND TUBULAR IMPELLER PUMP**

Offers the flexibility to use either the open impeller or the tubular impeller on the same pump, providing more versatility to meet specific needs in your process.

*We present the RA and RT Multisteel Pumps Lines, designed for dealing with dirty, dense, and viscous liquids, such as paper pulp, syrup, and acids.*

*With the two-channel impellers and rear blades, these pumps ensure efficient and reliable pumping in several industrial applications.*

*Designed to offer high performance and energetic efficiency, ensuring resource optimization and operational cost reduction.*



### **Conformity with Standards**

It meets standards NR12, ANSI 16.5, and ASME B73.1, ensuring safety and equipment quality for your industrial operations.



### **Back Pull-Out System**

It has a "Back Pull Out" system for disassembling, a smart solution that allows fast and uncomplicated maintenance. With such a system, you can remove the pump's rear part without having to disconnect pipings or disassemble the pump structure. This saves time and resources, making inspection, cleaning, and replacing parts easier, ensuring maximum operational efficiency, and reducing equipment's stop time.



### **Interchangeable Wear Plate**

Our pumps are built with an interchangeable wear plate, making maintenance easier and extending the pump's useful life, ensuring consistent performance throughout time.

**350  
m<sup>3</sup>/h**

### **Operation Data**

Sizes Available: from 50 to 150  
Flow: 5 - 350m<sup>3</sup>/h  
Manometric Height: 5 to 60 mca  
Rotation: up to 3500RPM

